

Model X2 Push Button Station

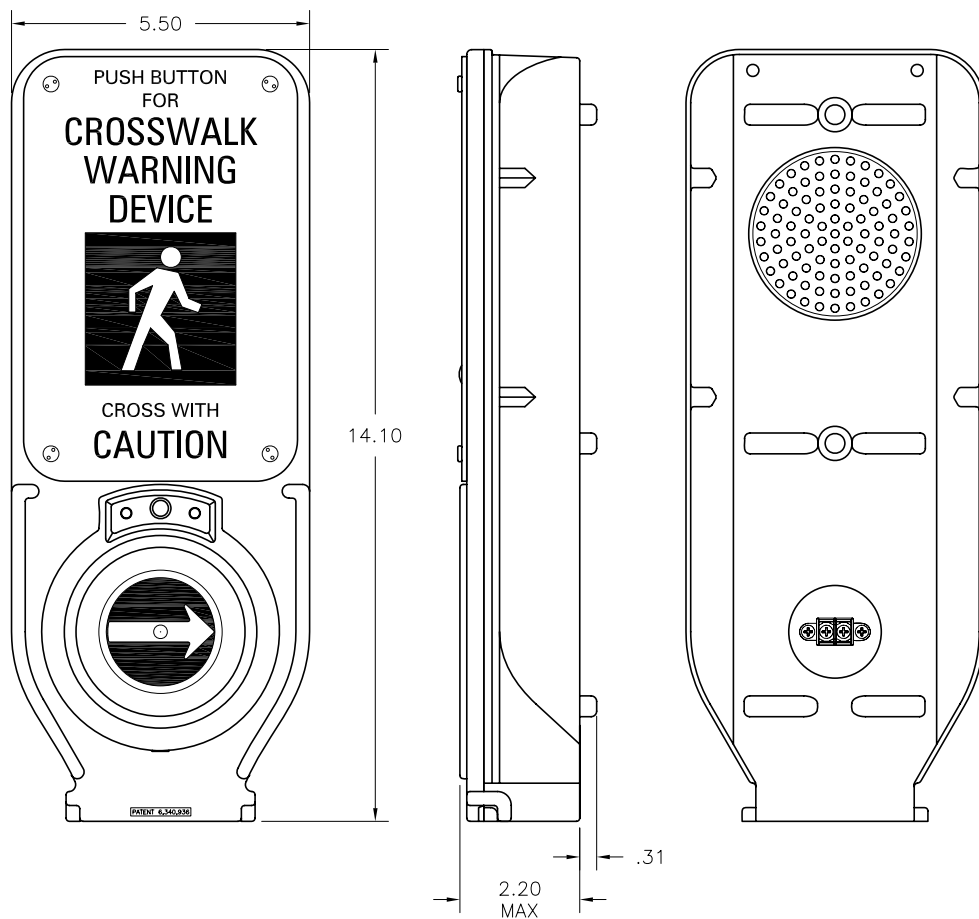

The X2 push button station is designed for use at a pedestrian crosswalk with in-pavement or overhead flashing yellow lights. The X2 provides an instructional sign and a push button station with directional arrow for activating the flashing lights. The X2 uses the same rugged and reliable push button station and housing as Polara's Navigator.

A two position terminal block on the rear of the X2 allows connections for a pair of wires. Pressing the button provides a contact closure. The switch is solid state piezo activated.

The unit is supplied with mounting hardware and installation instructions.

Electrical Properties

Push Button	
Wire connections	2 position terminal block, no polarity
Operating voltage	10-36VDC, 7-28VAC
Maximum Switch Current	0.5A
Switch Leakage Current	10µA typical

Features

- Instructional sign with tamper resistant mounting screws.
- ADA compliant push button with directional arrow - field adjustable direction: left, right, up or down.

Mechanical Properties

Physical	
Enclosure Type	Cast aluminum housing with yellow powder coat finish, watertight o-ring seals
Installation	2 holes on 6.0" centers, tapped ¼-20 plus ½" or larger hole for wire access
Dimensions	
Width	5.50"
Length	14.10"
Maximum Height	2.60"
Environmental	
Operating/Storage Temp.	-34°C to +60°